

PHILIPS
RESPIRONICS

BiPAP

A40 Pro and EFL

Accessory guide





Table of contents

- 3 Power, mobility, cases and roll stand
- 5 Supplemental low flow O₂ support
- 8 Personalized circuits
- 9 Humidification
- 11 SPO₂ - modems, oximeters and probes
- 13 Cellular modems and data connections
- 14 Screening and therapy masks



BiPAP A40 EFL



BiPAP A40 Pro

BiPAP A40 EFL and BiPAP A40 Pro extended warranties

Part number	Description
EXT3000S19	1-year extended warranty
EXT3000S20	2-year extended warranty
EXT3000S21	3-year extended warranty

Power, mobility, cases and roll stand

Experience complete mobility

BiPAP A40 Pro and BiPAP A40 EFL empower clinicians and patients with the ability to easily travel and provide a sense of freedom while transitioning from one point to another. The device accessories can also give patients at home the confidence that their therapy can be on demand, regardless of their power situation.



BiPAP A40 in-use case
(1098513)



BiPAP A40 carrying case
(1098514)



Mounting plate
(1115268)

O₂ tank holder
(1115269)

Roll stand
(1098538)

Cases

Part number	Description
1080095	Philips RI ANIV (BiPAP A30) carrying case
1098513	BiPAP A40 in-use case
1098514	BiPAP A40 carrying case

Roll stands and roll stand accessories

Part number	Description
1098538	Roll stand, BiPAP A-Series
1115268	Roll stand mounting plate, BiPAP A-Series
1115269	Roll stand O ₂ tank holder, BiPAP A-Series



Power cords



**Detachable battery module
(3000DBM)**



**Detachable battery Pack
(1043570)**



**Respiratory Li-Ion
battery kit, International
(1126944)**

Power cords

Part number	Description
1038928	North America power cord
1039014	Europe power cord
1039012	Australia power cord
1074365	Brazil power cord
1039027	Japan power cord
1039026	UK power cord
1141448	Korean power cord
1060017	India power cord

Power, batteries and cables

Part number	Description
1142982	A-Series power supply - 100W
3000DBM	Detachable battery module, USA/INTL
1043570	Detachable battery pack, USA/INTL
1001956	Shielded DC power cable - requires fuse 1008104
1008104	DC power cord fuse, 7 amp
532209	DC battery adapter cable (has alligator clips to connect to marine battery)

External battery kits and parts

Part number	Description
1124010	Respiratory Li-Ion battery kit, North America (Canada)
1126944	Respiratory Li-Ion battery kit, International
1126945	Respiratory Li-Ion battery kit, Japan
1126946	PAP / Respiratory Li-Ion battery, RP (replacement battery)
1121737	Li-Ion battery, Trilogy cable
1121879	Li-Ion battery, BiPAP device cable, (BiPAP A40 Pro and BiPAP A40 EFL)
1120136	DreamStation travel supply, 65W - power cord not included

Supplemental low flow O₂ support

Multiple therapies, simplified

Supplemental O₂ simplified and integrated - up to 15 liters per minute (at 10 psi)



O₂ enrichment attachment connector (1040390)

Integrated Supplemental low flow O₂ support

Part number	Description
1040390	Trilogy, oxygen quick-connect insert, 2 Pk - Oxygen inlet adapter

Supplemental low flow O₂ support - patient circuit adapters

Part number	Description
312710	O ₂ enrichment attachment connector
302418	Pressure relief valve
C06334	Connector / M 22mm ID, Female
1044191	CoughAssist adapter, 22 mm X 15 mm OD - Connects circuit to pressure relief valve



Connector / M 22mm ID, Female (C06334)



Not all products are available in all markets.



Straightforward personalized circuits

For every patient and every need

The Philips Respironics family of circuits are designed to deliver quality respiratory care to pediatric and adult patients with a wide variety of needs.



**15mm heated tube
(DreamStation)
(HT15)**



**15mm heated tube
(DreamStation)
(PR15)**

Noninvasive PAP circuits

Part number	Description
1007800	Tubing 6 ft., high-temp (22mm)
HT15	15mm heated tube (DreamStation)
PR15	15mm tube (DreamStation)
1032907	System One performance tubing 6 ft. (22 mm)



**Pollen (foam) filter
(1029330)**



**Bacteria filter
(342077)**



**Whisper Swivel II
(332113)**

Device filters

Part number	Description	Box quantity
1029330	Pollen (foam) filter, reusable	2/pack
1035442	Ultrafine filter, disposable	2/pack
1029331	Ultrafine filter, disposable	6/pack

Inline filters and exhalation connector

Part number	Description	Box quantity
C06417	Filter, bacterial, disposable	
342077	Bacteria filter	10/pack
C06418	Filter, bacterial, disposable	50/pack
332113	Whisper Swivel II	

Integrated humidification

Breathe more comfortably with adjustable humidification



Heated tube humidifier (INX3T)



System One 60 Series water tank (1136502)

Heated humidifier (INX3H)

Heated humidifiers

Part number	Description
INX3H	A40 Pro/EFL, Sys One Heated Hum, INTL
GBX3H	A40 Pro/EFL, Sys One Heated Hum, GB
FRX3H	A40 Pro/EFL, Sys One Heated Hum, France
ITX3H	A40 Pro/EFL, Sys One Heated Hum, Italy
DEX3H	A40 Pro/EFL, Sys One Heated Hum, Germany
NDX3H	A40 Pro/EFL, Sys One Heated Hum, Nordics
ESX3H	A40 Pro/EFL, Sys One Heated Hum, Iberia
BLX3H	A40 Pro/EFL, Sys One Heated Hum, Benelux

Heated tube humidifiers

Part number	Description
INX3T	A40 Pro/EFL, Sys One Heated Tube Hum, INTL
GBX3T	A40 Pro/EFL, Sys One Heated Tube Hum, GB
FRX3T	A40 Pro/EFL, Sys One Heated Tube Hum, France
ITX3T	A40 Pro/EFL, Sys One Heated Tube Hum, Italy
DEX3T	A40 Pro/EFL, SysOne Heated Tube Hum, Germany
NDX3T	A40 Pro/EFL, Sys One Heated Tube Hum, Nordics
ESX3T	A40 Pro/EFL, Sys One Heated Tube Hum, Iberia
BLX3T	A40 Pro/EFL, Sys One Heated Tube Hum, Benelux

Water tank

Part number	Description
1136502	PR System One 60 Series water tank (replacement water tank)



SPO₂ - modems, oximeters and probes

Patient safety, simplified

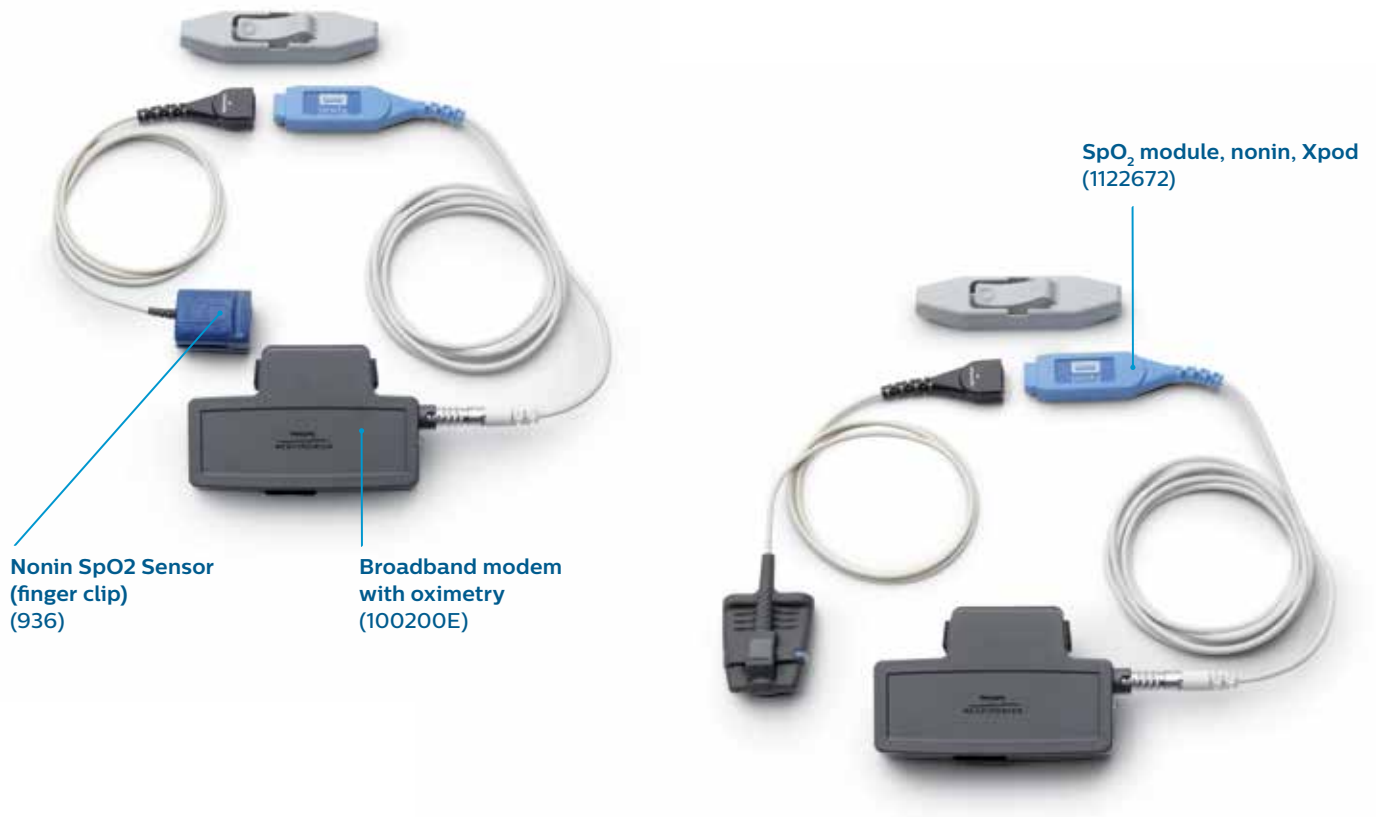

SPO₂ - modems, oximeters and probes

Part number	Description
100215E	Broadband / oximetry accessory, INTL
100225E	Broadband / oximetry accessory, JP
100245E	Oximetry accessory, RoHS, EU



Nonin

Part number	Description
1122672	SpO ₂ module, nonin, Xpod
936	Nonin SpO ₂ Sensor (finger clip)
1062049	Nonin finger soft sensor, large
1062050	Nonin finger soft sensor, medium
1062051	Nonin finger soft sensor, small

Cellular modems and data connections

Monitor and communicate



Cellular modem



Cellular modem on back of device

Cellular modems and data connections

Part number	Description
100226C	PRI Cellular Modem, EU
100230C	PRI Cellular Modem, Japan
100215C	PRI Cellular Modem, Australia/Canada/Latin America - No Brazil

Modules

Part number	Description
1061644A	Philips Respironics Link Module - Service only item
100200B	Bluetooth Accessory Module, Domestic/USA
100210B	Bluetooth Accessory Module, Canada
100220B	Bluetooth Accessory Module, International



SD card

Part number	Description
1047300	SD Card Reader
1063859	Philips RI SD Cards, 10/pack

BiPAP A40 EFL: Screening masks

AF541 SE Oro-Nasal mask

Note: All sizes can also be used as therapy masks

Part number	Description
1120940	Small, AF541 SE, 4PT HDG, 10/pack
1120941	Medium, AF541 SE, 4PT HDG, 10/pack
1120942	Large, AF541 SE, 4PT HDG, 10/pack
1120943	Extra large, AF541 SE, 4PT HDG, 10/pack
332113	Whisper Swivel II Exhalation Device is required for AF541 oronasal mask as a leak mechanism

Pico traditional nasal mask

Part number	Description
1104940	S/M, L, XL, Pico nasal mask fit-pack with headgear



AF541 SE Oro-Nasal



Pico traditional nasal

BiPAP A40 EFL: Therapy masks

Note: All sizes and frame styles are supported for the following masks

Description

- Amara full face mask
- Amara Gel lab mask
- Amara View full face mask
- ComfortGel Blue full face mask
- ComfortGel Blue nasal mask
- DreamWear full face mask
- DreamWear nasal mask with Under the nose cushion
- DreamWisp nasal mask with over the nose cushion
- Pico traditional nasal mask
- True Blue mask
- Wisp mask



Amara full face



Amara Gel lab



Amara View full face



ComfortGel Blue full face



ComfortGel Blue nasal



DreamWear full face



DreamWear nasal



DreamWisp nasal



True Blue



Wisp

Please reach out to your local representative for more details.

Not all products are available in all markets.



© Koninklijke Philips N.V., 2020. All rights reserved.
Specifications are subject to change without notice.
Trademarks are the property of Koninklijke Philips N.V. or their respective owners.
800 345 6443 • 724 387 4000
www.philips.com/respironics

 Respironics Inc.
1001 Murry Ridge Lane
Murrysville, PA 15668 USA

 Respironics Deutschland GmbH & Co. KG
Gewerbestrasse 17
82211 Herrsching, Germany



RB 12/7/20
MCI 4108767 PN 1142129 v01